

MC
TM

HSI-MLxxxxx

- Use to lift and transport steel and iron for
Factories, docks, warehouses, transportation
And more.
- Turning the manual handle activates or turns
Off the magnet.
- Strong attraction gives this tool a powerful lifting
Ability while it's small size and light weight
Makes it easy and safe to operate. Effective for
Long periods with no need for a power supply.
- Permanent magnet.
- Safety Factor 3.5



Item No.	Max. Load Plate	Max. Load Round	L	B	H	R	Net Weight
HSI-ML00220	220 lbs	110 lbs	2.5 po 62 mm	3.7 po 92 mm	2.7 po 67 mm	5.0 po 126 mm	6.6 lbs
HSI-ML00660	660 lbs	330 lbs	3.7 po 92 mm	6.5 po 162 mm	3.6 po 91 mm	6.2 po 155 m	22 lbs
HSI-ML01320	1320 lbs	660 lbs	4.9 po 122 mm	9.3 po 232 mm	4.7 po 117 mm	7.8 po 196 mm	52 lbs
HSI-ML02200	2200 lbs	1100 lbs	7.0 po 176 mm	10.3 po 258 mm	6.5 po 163 mm	11.4 po 285 mm	110 lbs
HSI-ML04400*	4400 lbs	2200 lbs	9.4 po 234 mm	15.1 po 378 mm	8.5 po 212 mm	17.0 po 426 mm	275 lbs
HSI-ML06600*	6600 lbs	3300 lbs	11.4 po 286 mm	18.3 po 458 mm	10.4 po 261 mm	20.8 po 521 mm	484 lbs
HSI-ML13200*	13200 lbs	6600 lbs	17.2 po 430 mm	24.0 po 600 mm	14.2 po 355 mm	7.2 po 180 mm	924 lbs

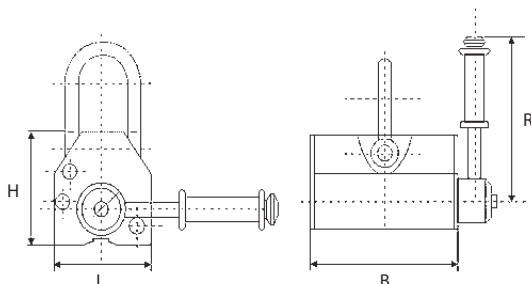

Authorized distributor: